



**Description of the system:**

The Sky evolution of long lasting and proven system S 100 allows maximum open space transparency in combination with large flexibility and multiple layout possibilities.

The S 100 Sky double-pane dividing partition is composed of an alu structure made up of extruded aluminium profiles and two parallel rows of glass plates placed one after the other, with a total thickness of 100 mm. The particular structure of the base (primary) profile accommodates different glass and blind panel thicknesses (up to 12 mm). The open-profile mounting system allows the glazed panels to be mounted flush to the base profile. The glazed panels are made of safety glass and self-supporting, 10 mm thick for heights of up to 3,20 m and 12 mm above this up to 3.80 m. Vertical joints between glass and glass and HPL panels are obtained gluing the glass together with a special very thin film of transparent bi-adhesive; it is also possible to use an extruded aluminium profile with the same section.

Thanks to its double glazing S 100 Sky meets the requirements of high soundproofing performance and height.

The continuous search for cutting-edge technical solutions and the great care for details have allowed us to reach, with our S 100 Sky walls, extremely high sound insulation levels



## Glass partition S 100 Sky

Construction:	Double glazed, studless glass-only construction
Dimensions:	Object - related measurements
Joints:	Transparent bi-adhesive 3M tape / extruded aluminium profile with glass section
Wall thickness:	100 mm.
Module width:	up to 1200 mm.
Substructure:	alu structure made up of extruded aluminium profiles, RAL coloured or anodized
Height:	10 mm. toughened / laminated safety glass - up to 3200 mm. 12 mm. toughened / laminated safety glass - up to 3800 mm.
Weight:	10 + 10 mm. safety glass - about 58 kg / sqm 12 + 12 safety glass - about 68 kg / sqm
Sound insulation:	10 mm. toughened + 10 laminated safety glass - 45 dB 12 mm. toughened + 12 laminated safety glass - 48 dB 12 mm. laminated sound isolation foil + 12 laminated safety glass - 52 dB
Wall connections:	anchor connections to solid walls / floor / ceiling
Tolerances:	up to 35 mm. deflection in floor / ceiling measure
Doors:	Solid door leaf tubular chipboard inlay RAL painted surface Solid door leaf tubular chipboard inlay HPL surface Solid door leaf tubular chipboard inlay real wooden veneer surface 10 mm. tempered fully glass door leaf
Glass thickness:	10 / 12 mm. safety (tempered or laminated) glass panels
Viewing profile:	no / up to 20 mm., RAL painted possibility different from main profile aluminium profile visible width - 40 mm.
Fire protection:	F 0
Wall type:	Non load bearing partition wall
Surface:	Glass - transparent / foiled / sandblasted / painted Side panels - RAL painted / HPL / veneered



## Glass partition S 100 Sky

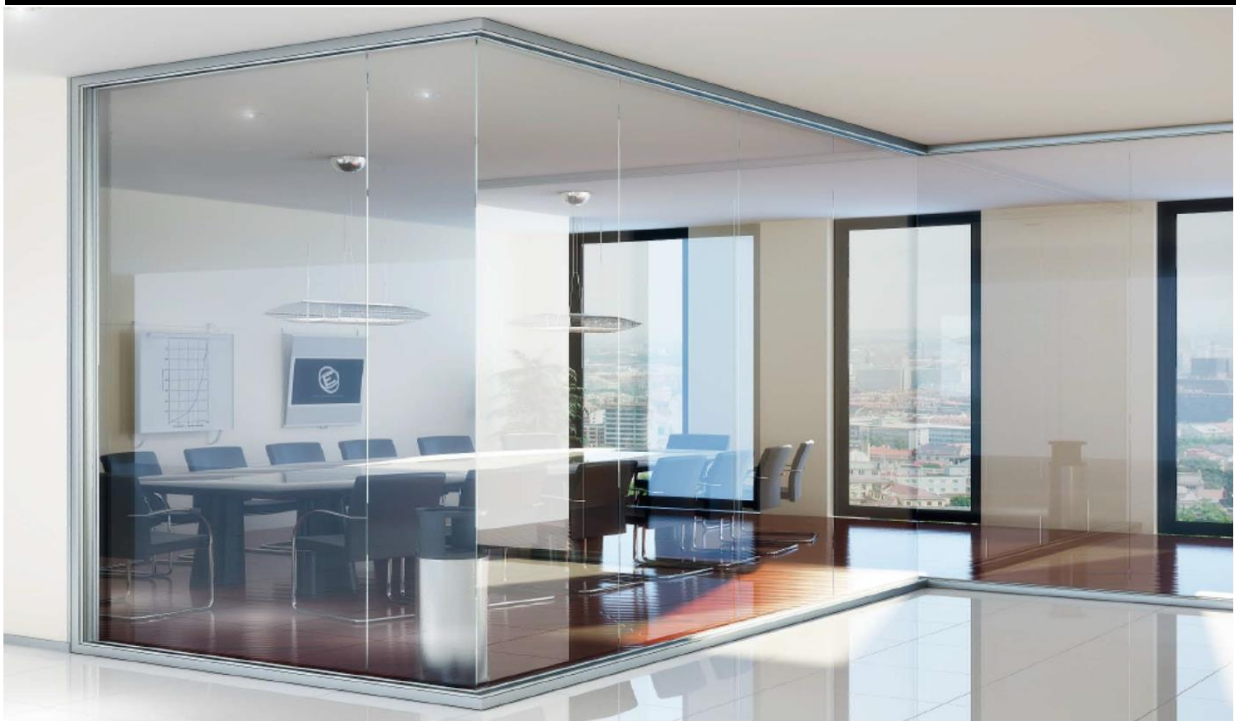

The S 100 Sky dual structural pane partition system adds excellent soundproofing to characteristic transparency and lightness. Perfect integration of all parts allows complete, optimised design solutions to be achieved

The glazed panels used are self-supporting, 10 mm thick for heights of up to 3,20 m and 12 mm above this up to 3.80 m. All panels are made of safety glass, either laminated with 0.38 or 0.75 mm PVB film placed between the plates, or else tempered, that is treated with a toughening process which gives them increased strength (up to five times greater than normal glass). The glass can be personalised using different technologies which give it different optical and aesthetic characteristics:

- by the addition of colouring to the molten glass. This colours it but nevertheless leaves it transparent;
- by treating its exterior, making the treated surfaces opaque. Treatments include acid etching, grinding and digital screen printing;

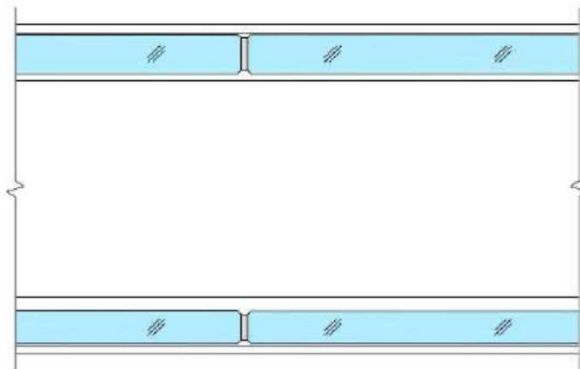

- by painting and/or the application of coloured or printed films to the interior or exterior of the glazed panels;
- by inserting various materials inside the extra-clear glass sheets, such as veneers, fabrics, silks, papers, fine mesh, marble, photographs, leaves etc.